

Smart Gateway Quick Operation Guide

M420-3Ever1.0

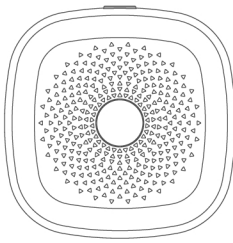

*Please read the user manual carefully before operation. The guide picture is for reference only, please in kind prevail.

1 Product Description

This smart gateway, adopting super low power consumption ZigBee technology, can work with kinds of smart sensors and smart home appliances to build a smart home system and the gateway works as the central controller. Built-in WiFi module support direct connection to user's household WiFi network. Its acousto-optic alarm function which can keep user informed of any emergency circumstance. The gateway also has night light function, and changeable EU, UK and US plug for option.

2 Product Details

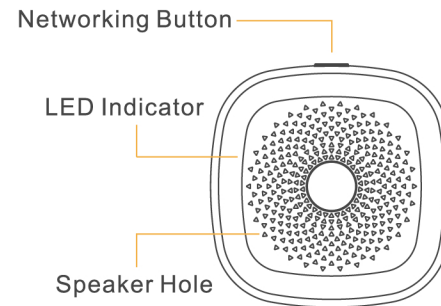

3 Specification

- Working voltage: AC100V~240V
- Average power: 2W (max 5W)
- ZigBee HA Protocol
- Wireless networking distance: ≥100m (open area)
- WiFi: IEEE 802.11b/g/n 2.4GHz
- Working temperature: -10°C~+50°C
- Working humidity: ≤95%RH
- Dimension: 70*70*52mm

4 Quick Setup

Scan the QR code to download App, and sign up with valid email, log in e-mail box and activate your account.

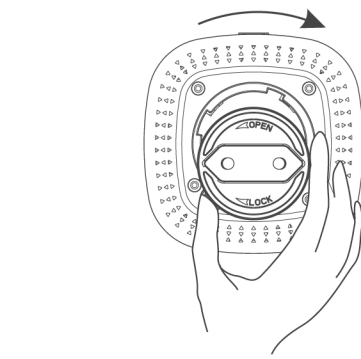

- Rotate the plug into power connector of smart gateway.

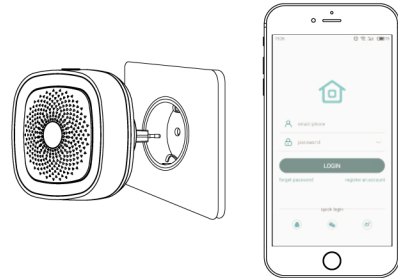

- Plug smart gateway into home socket to power on, connect smart phone into available WiFi network. Then open APP, input user account and password to login.

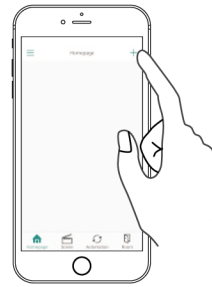

- On APP homepage, tap "+" and "Add Device", then choose "Mini Gateway" to enter into gateway installation instruction page, after that, tap "NEXT" to enter into gateway configuration.

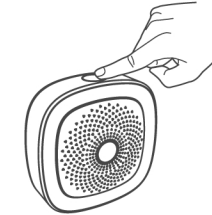

- After enter into gateway configuration, press and hold the networking button for 5 seconds, then the red LED will flash, after that, input the WiFi password and click "Configuration", the gateway starts to connect to WiFi, the red LED will keep on for 0.2 seconds and die out, which indicates that gateway connects to WiFi successfully.

Networking Button Instruction

Status	Operation
WiFi configuration	Press and hold the networking button for 5 seconds, the gateway will enter WiFi configuration mode.
Network configuration	When the gateway is under standby status, press the network button twice in succession and the gateway will enter ZigBee network configuration mode.
	When under ZigBee network configuration mode, press the network button twice in succession and the gateway will exit ZigBee network configuration mode.

Status	Operation
Mute	When the gateway is alarming, press the network button and the alarm will be turned off. When there is new alarm condition, the gateway will be alarming again.
Reset	Press the network button ten times in succession and the gateway will be reset: delete all ZigBee devices, delete all connections between gateway and App, delete all WiFi configuration information.

LED Indicator Status Instruction

LED indicator	Status
Light Off	When gateway is working normally and gateway is already connected to WiFi, LED is off.
Yellow	When gateway is offline or WiFi is unavailable, yellow LED flashes slowly(once every 3 seconds).
Blue	When gateway is preparing to include devices, blue LED flashes (twice per second).
Green	When ZigBee devices are included successfully, green LED flashes quickly(5 times per second).

LED indicator	Status
Red	When gateway is powering on, red LED keeps on for 0.2 seconds and die out.
	While setting gateway WiFi, red LED flashes slowly(once per second).
Purple	When gateway alarm is sounding, red LED flashes(twice per second).
	When ZigBee Firmware is updating, purple LED flashes(twice per second).
White	When WiFi Firmware is updating, white LED flashes(twice per second).

5 Voice Prompts

- Tap "Disarm" in APP, gateway sounds "disarm".
- Tap "Arming(home)" in APP, gateway sounds "arming at home".
- Tap "Arming(away)" in APP, gateway sounds "arming away".
- Gateway sounds alarm when other devices are sounding alarm.
- Alarm duration and alarm volume can be set in APP.

6 Adding Devices



On App Homepage, click "+", Select "add a device" to add needed ZigBee device, and the App will change to Device guidance page, click "NEXT" to enter "Add devices" page, and the blue LED indicator of the gateway will flash(twice/seconds) to wait for a new ZigBee device to be added in.

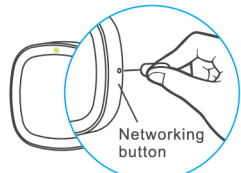

Smart Motion Sensor

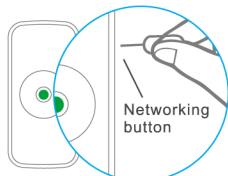

Smart Door Sensor

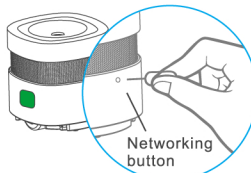

Smart Smoke Sensor

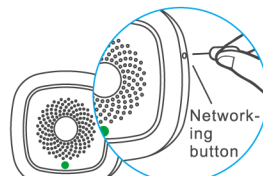

Smart Temperature & Humidity Sensor

Adding devices: According to APP prompt, when blue LED of gateway flashes quickly, then press and hold the networking hole of device that needs to be added to gateway with a needle for 2 seconds, till the green LED of device flashes quickly, next, the green LED of the device will keep on for 3 seconds, after that, the device photo will be shown in APP, indicating that device is added to gateway successfully.

Removing devices: Press and hold the networking hole of the device that needs to be deleted from gateway with a needle for 5 seconds, then the green LED of the device will flash slowly for 3 seconds, indicating that device is deleted from gateway successfully. Or long press the device in the APP and tap "Delete Device" to delete.

Statements:

*Illustrations are for reference only.
*As the technology updates, there may be differences between user manual and actual operations, and the final interpretation rights is owned by the manufacturer.