

PRODUCT INTRODUCTION

This product is digital infrared motion detector with high stability. It adopts dual sensor signal processing technology and provides superhigh detection and anti false alarm performance, and MCU processing ensuring its reliability from the design basis. Any intruder passing through the detection area, the detector will automatically detect the movements of human body and pets. If Any dynamic movement, it will send the alarm signal to the mainframe. This product is suitable for the safety in residential areas, villas, factories, shopping malls, warehouses and office buildings etc.

PRODUCT PROFILE

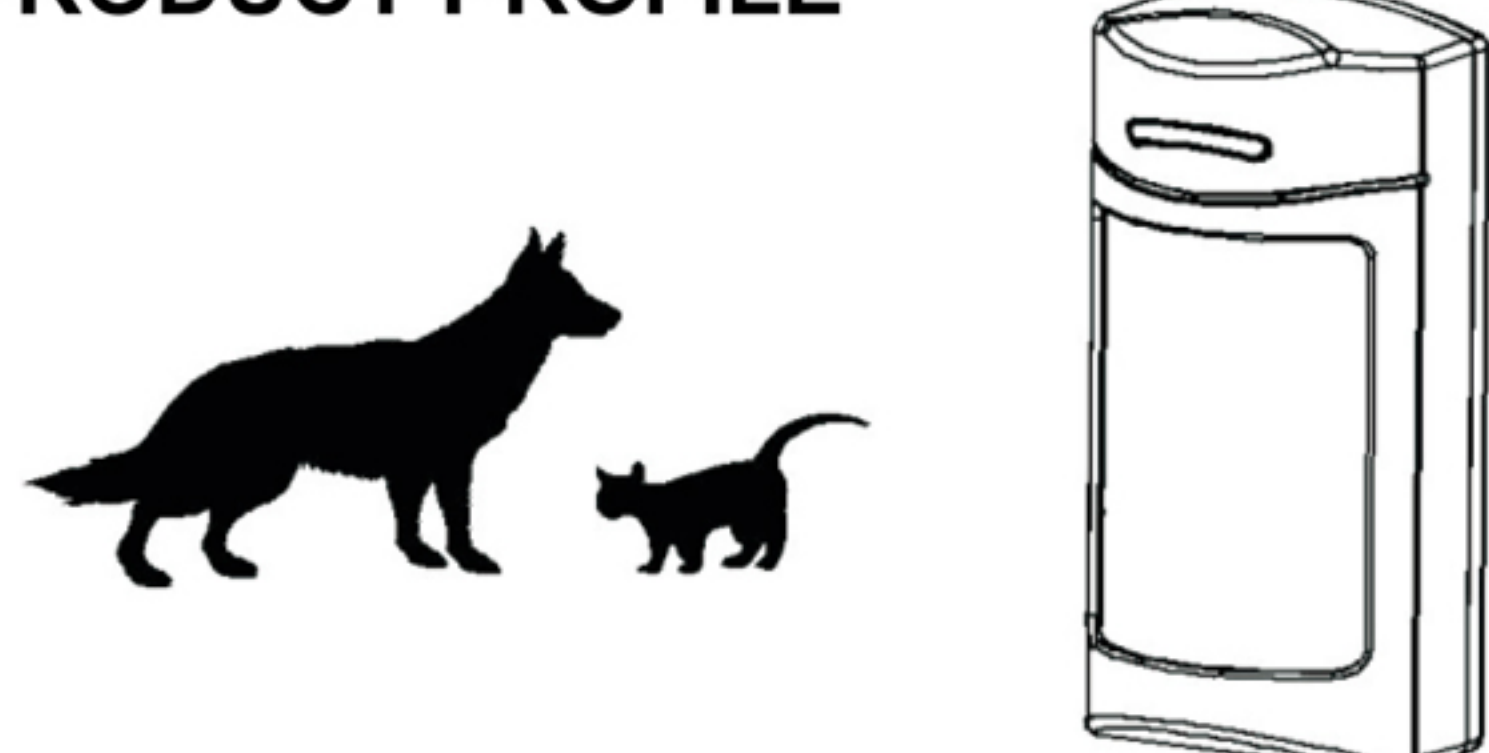

TECHNICAL SPECIFICATIONS

- Working voltage: DC 9-24V
- Consumption Current: 18mA
- Detecting Distance: 12 m
- Detecting Angle: 110 degrees
- Detecting Speed: 0.3m/s~ 3m/s
- PIR sensitivity adjustment availability
- Adjustable immunity
- Self-Testing Time: 60s
- Alarm Delay Time: 3s/30s optional
- Alarm Indication: Red LED with on / off availability
- Sensor: Double element pyroelectric infrared sensor
- Operating Temperature: -10°C ~ +50°C
- Wired connection feeding 12 volts
- Environment Humidity: Max 95% RH (no congelation)
- Anti-RF interference: 10MHZ~1GHz 20v/m
- Installation Mode: Wall or corner mount
- Alarm Output: NC/NO optional, contact rated at DC28V 100mA
- Tamper Output: NC, contact rated at DC28V 100mA
- Install height: recommend 2m

FEATURES

- EN 50130 certified
- MCU control, high efficiency of anti false alarm
- Dual Sensor technology, real pet-immunity
- Immunity (25kgs)
- Dual-mode Temperature Compensation
- Dynamic Thresholds Adjustment Technology
- Bipolar Pulse Count Adjustable
- Anti White Light Interference, Anti RF Interference
- Fresnel Lens
- Alarm Output N.C./N.O. Optional
- Alarm Delay Time Optional (3s/30s)
- SMT Manufacture Technology, Stabler Performance
- Wall mounted

INSTALLATION CONDITIONS

1. For good pet immunity performance, the installation height is recommended not lower than 2m. Mount the detector flat on a wall or in a corner. Do not angle it downwards.
2. Avoid placing the detector in outdoors, near a air-conditioner or a heat source, in direct sunlight, beneath a rotating object and near fluttering curtains. Do not place objects about 1.8m high in front of the detector, that a pet can jump onto and pet immunity will be reduced.
3. Surface of installation should be firm with no vibration.
4. Mount the detector where an intruder passes easily.

INSTALLTION HINTS

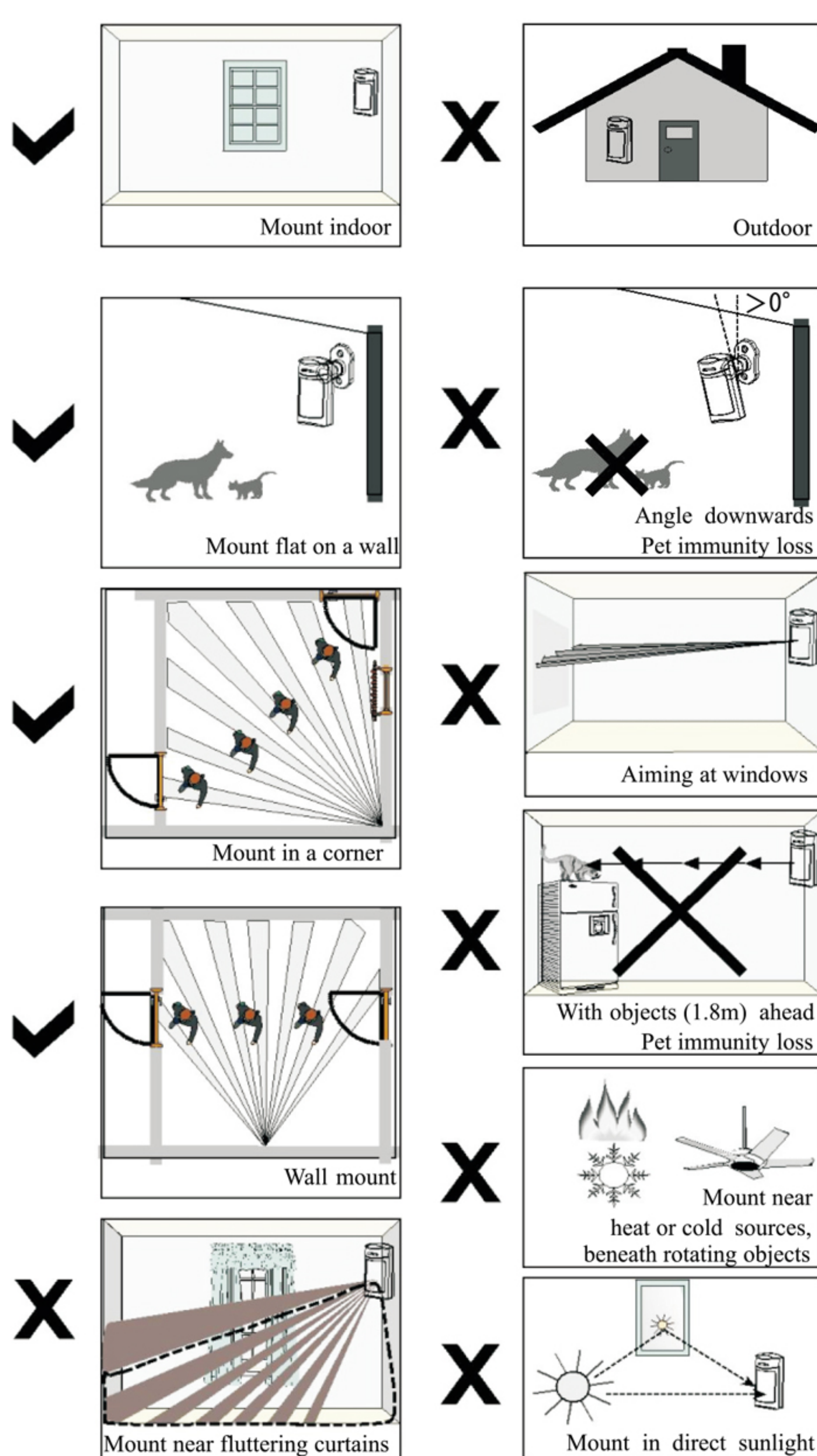

WIRING INSTRUCTIONS

- Red wire: positive DC power
- Black wire: negative DC power
- Yellow wire: tamper output
- White wire: alarm output

INSTALLATION STEPS

1. Install the detector on a suitable position. Cut off the thin plastic in the bracket if open wire installed.
2. Connect the power wire and signal wire as wiring instruction.
3. Screw the detector into the bracket (the click sound says well-installed). Adjust the install angle as needed.

INSTALLATION ILLUSTRATIONS

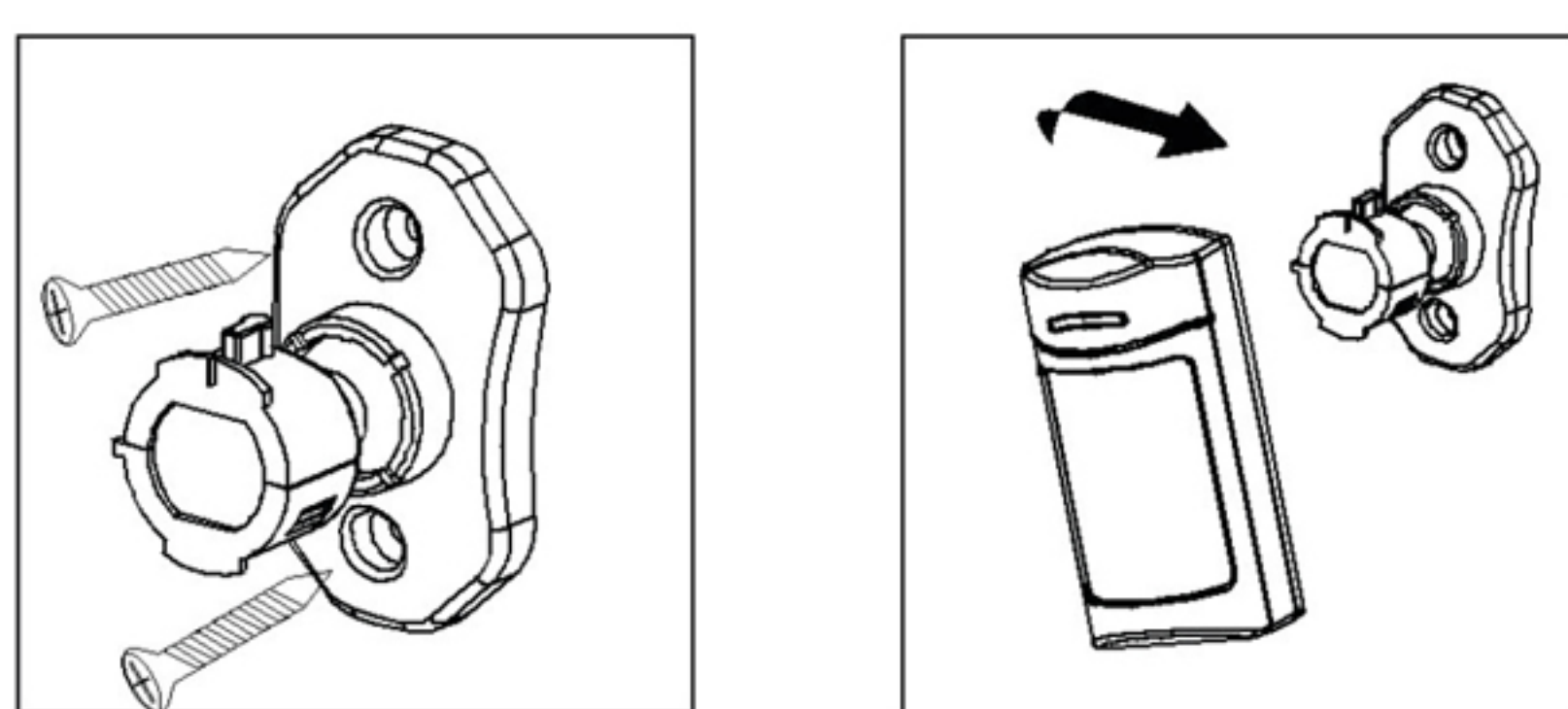

OPERATING INSTRUCTION

1. Function setting refer to figure three
 - (1) Pulse jumper: Adjust the pulse count to change the sensitivity and anti RF interference ability.
 - Short 1&2: Class 1 pulse, high sensitivity and strong anti RF interference, adapt to general environment.
 - Short 2&3: Class 2 pulse, low sensitivity and stronger anti RF interference, adapt to the environment with serious RF interference.
 - Factory setting is Short 1&2 (class 1 pulse).
 - (2) Relay jumper: Choose N.C./N.O. to set the status of alarm output. You can choose the different output in accordance with the alarm mainframe.
 - Short 1&2: N.O. (normally open)
 - Short 2&3: N.C. (normally closed)
 - Factory setting is Short 2&3 N.C. (normally closed)
 - (3) Delay jumper Alarm delay time is the duration of the alarm indicator before alarm.
 - Short 1&2: delay 3 sec.
 - Short 2&3: delay 30 sec.
 - Factory setting is Short 1&2, delay 3 sec.
 - (4) LED jumper
 - For setting LED ON/OFF, no effect to the detect normal work. LED can be shut off for the concealment of the detector after test.
2. Product testing
 - Turn on the power and the indicator on. The detector comes into auto-check status for about 60 sec. LED indicator turns off and the detector comes into normal detecting status. The tester should walk parallel with the wall installed detector in the testing area. LED indicator turns on, which indicates the detector is in alarm status.

JUMPER SETTING FIGURE

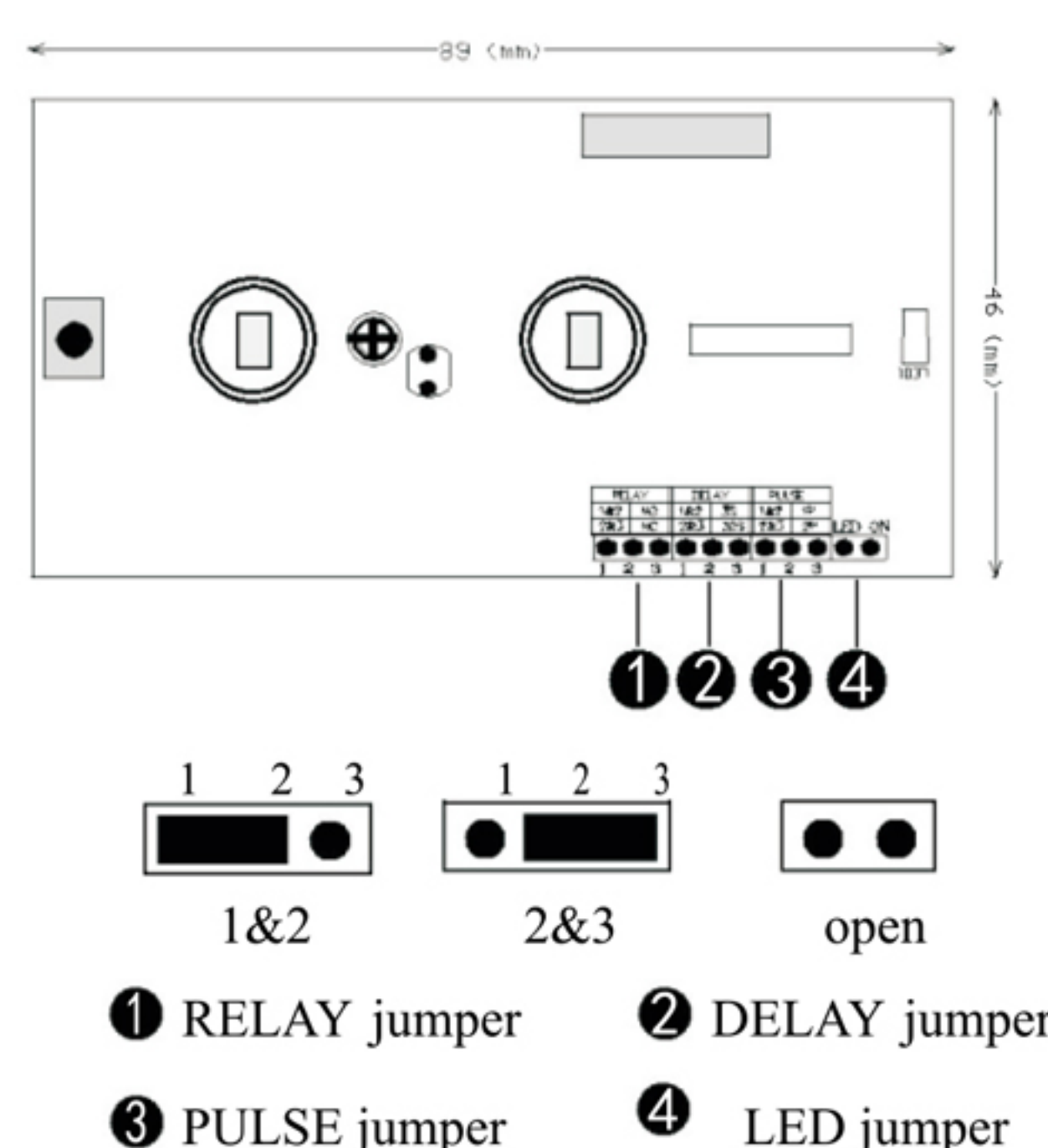

NOTICE

1. Please install and use the detector as the manual instructed. Any detector failure, please inform management center or our company after-sales service center for repair.
2. The product can reduce accident, but cannot ensure no risk at all. For your safety, in addition to the proper use of this product, remain vigilant in your daily life and strengthen security prevention consciousness.
3. In order to guarantee it can work well, the power should be kept to supply and conducted walking test periodically. Once a week is suggested.

DETECTING AREA VIEW

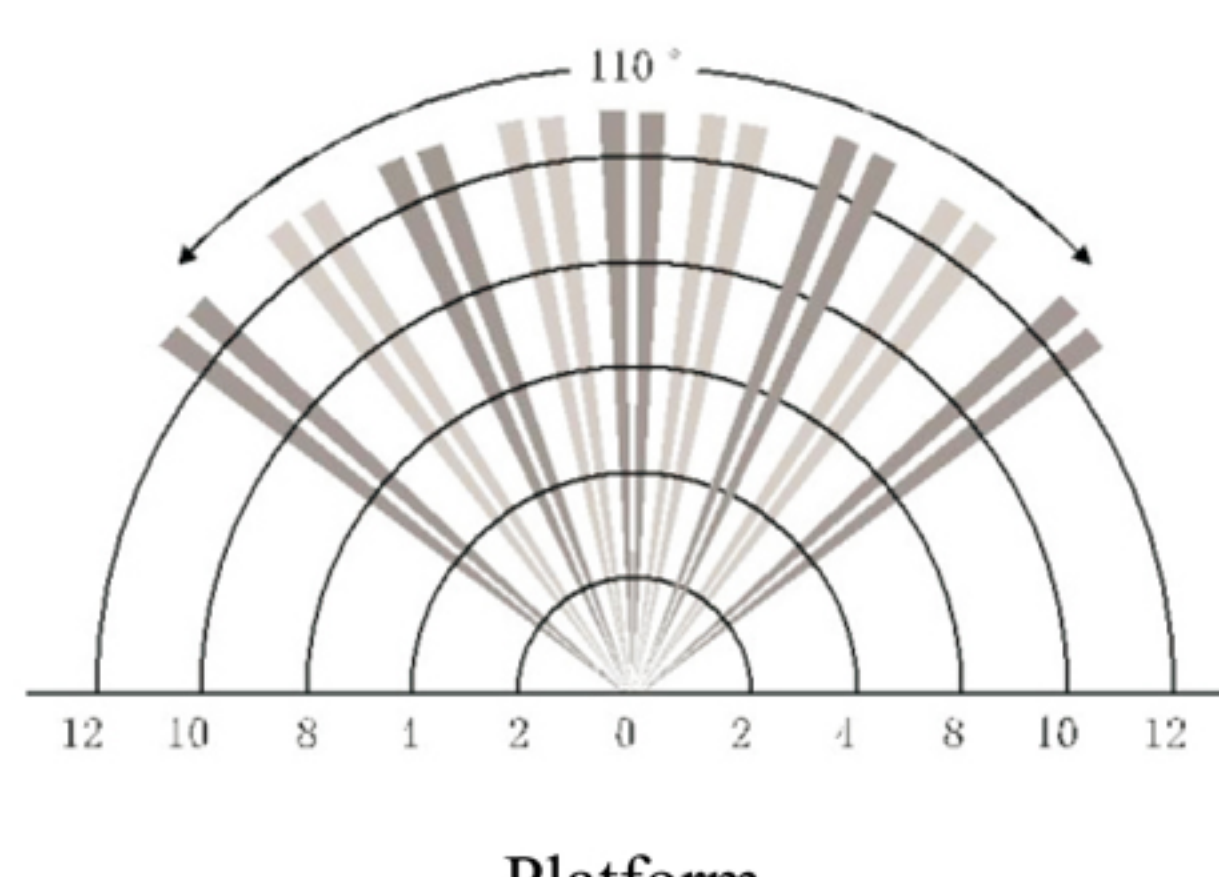

Platform

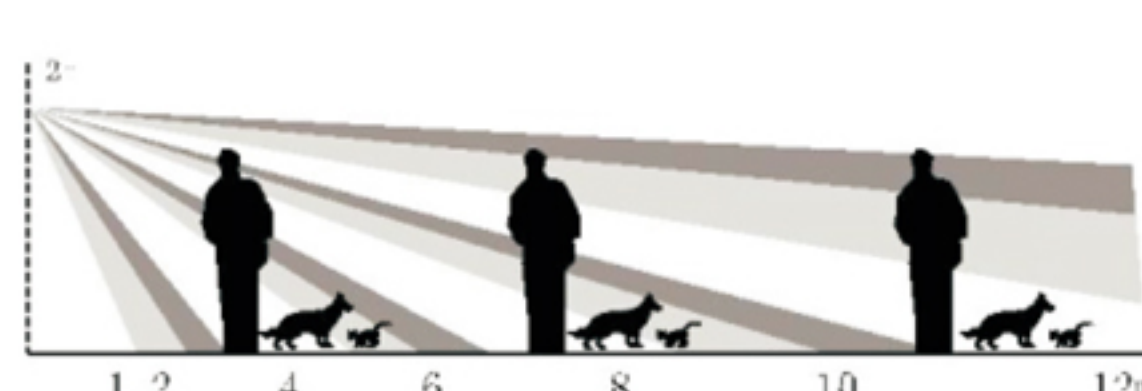

Side view